

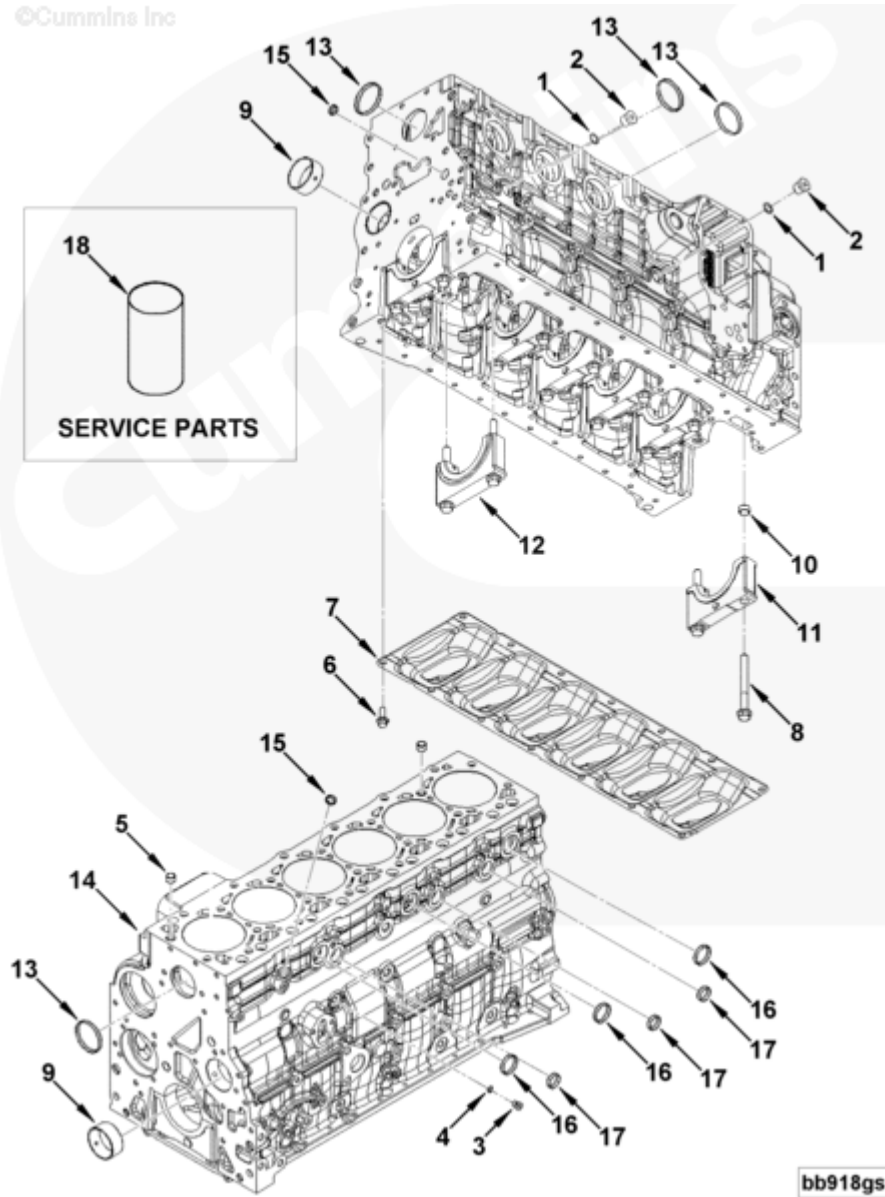

Parts Catalog - Option Detail

Electronic Parts Catalog - Option Detail				
Option	Group	Graphic	Film Card	Date
BB9410-02	01.01	bb918gs	T	15-JUL-13
Engines	4B3.9, 6A3.4, 6B5.9, B GAS INTERNATIONAL CM556, B4.5, B4.5 CM2350 B129B, B4.5 CM2350 B146C, B4.5 CM2350 B147B, B4.5 RGT, B4.5S, B5.9 G, B5.9 GAS PLUS CM556, B5.9 LPG, B5.9 LPG PLUS CM556, B6.7 CM2350 B121B, B6.7 CM2350 B135B, B6.7 CM2350 B136C, B6.7 CM2350 B148B, B6.7 G CMOH6.0 B125, B6.7N CM2380 B150B, B6.7S, F3.8 CM2350 F120B, F3.8 CM2350 F128C, F3.8 CM2350 F132B, F3.8 F102, G3.9, G5.9, G5.9 CM558, ISB (CHRYSLER), ISB CM2150, ISB CM2150 E, ISB CM550, ISB CM850, ISB/ISD4.5 CM2150 B119, ISB/ISD4.5 CM2150 SN, ISB/ISD6.7 CM2150 B120, ISB/ISD6.7 CM2150 SN, ISB/ISD6.7 CM2880 B126, ISB3.9 CM2220 B107, ISB4.5 CM2150, ISB5.9G CM2180, ISB6.7 2010 DCX PICKUP, ISB6.7 2013 DCX CHASSIS CAB, ISB6.7 CM2150 SQ, ISB6.7 CM2250, ISB6.7 CM2350 B101, ISB6.7 CM2350 B103, ISB6.7 CM2350 B142, ISB6.7 CM2670 B153B, ISB6.7 G CM2180 B118, ISBE CM2150, ISBE CM800, ISBE2/ISBE3 CM850, ISBE4 CM850, ISD4.5 CM2150, ISD6.7 CM2880 D101, ISF2.8 CM2220, ISF2.8 CM2220 AN, ISF2.8 CM2220 EC, ISF2.8 CM2220 ECF2, ISF2.8 CM2220 F101, ISF2.8 CM2220 F117, ISF2.8 CM2220 F122, ISF2.8 CM2220 F126, ISF2.8 CM2220 F129, ISF2.8 CM2220 IAN, ISF3.8 CM2220, ISF3.8 CM2220 AN, ISF3.8 CM2220 F103, ISF3.8 CM2220 F110, ISF3.8 CM2220 F116, ISF3.8 CM2220 F134B, ISF3.8 CM2220 IAN, ISF3.8 CM2350 F109, ISF4.5 CM2220 F123, ISG11 CM2880 G106, ISG11 CM2880 G108, ISG12 CM2880 G107, ISG12 CM2880 G109, ISG12 G CMOH6.0 G111, QSB3.9 30 CM550, QSB3.9 CM2880 B138, QSB4.5 30 CM550, QSB4.5 CM2150 B108, QSB4.5 CM2250 B131, QSB4.5 CM2250 EC, QSB4.5 CM2350 B106, QSB4.5 CM2350 B122			



SMALL | MEDIUM | LARGE

bb918gs

Cart	Ref No	Part Number	Part Description	Required	Remarks
View My Cart					
		BB9410-02	Cylinder Block		Cylinder Block...(More)
					High Speed Balancer: No
					Tapped Fittings: STORM
					Structural Block: No
					Oil Pan Flange Bolt Pattern
					(mm): 299 X 775.4
					Flywheel Housing Attachment
					Provision: 8 - M12 X 1.75 +
					2 - M10 X 1.50

					Front Engine Mount Pattern:
					320 mm Spread
					Non-Prepainted, Non-Siamese
					Non-Hardened Bores.
					May use 4991100 as an
					Alternative to 4991099.
<input type="checkbox"/>		3678873	Threaded Plug	2	M18 X 1.5 X 19.5
<input type="checkbox"/>	1	3678786	O-Ring Seal	1	M18
	2	3678791	Threaded Plug	1	M18 X 1.5 X 19.5
<input type="checkbox"/>		3678923	Threaded Plug	1	M10 X 1.00 X 13.5
<input type="checkbox"/>	3	3678924	Threaded Plug	1	M10 X 1.00 X 13.5
<input type="checkbox"/>	4	3678925	O-Ring Seal	1	M10.
<input type="checkbox"/>	5	3902343	Ring Dowel	2	
<input type="checkbox"/>	6	3903990	Hexagon Flange Head Cap Screw	7	M10 X 1.50 X 20.
<input type="checkbox"/>	7	5290910	Cylinder Block Stiffener	1	
<input type="checkbox"/>		5302096	Cylinder Block	1	
<input type="checkbox"/>	8	3927948	Fracture Resistant Screw	14	
<input type="checkbox"/>	9	4983253	Bushing	2	
<input type="checkbox"/>		3974157	Main Bearing Cap	6	
<input type="checkbox"/>	10	3900068	Ring Dowel	2	
	11	3974156	Main Bearing Cap	1	
<input type="checkbox"/>		3974159	Main Bearing Cap	1	
<input type="checkbox"/>	10	3900068	Ring Dowel	2	
	12	3974158	Main Bearing Cap	1	
<input type="checkbox"/>	13	4938189	Expansion Plug	5	
	14	4990447	Cylinder Block	1	
<input type="checkbox"/>	15	3900956	Expansion Plug	2	17.73 mm
<input type="checkbox"/>	16	3905401	Expansion Plug	3	
<input type="checkbox"/>	17	3914035	Expansion Plug	3	

<input type="checkbox"/>	18	4919951	Salvage Sleeve	A/R	

© 2019 Cummins Inc., Box 3005, Columbus, IN 47202-3005 U.S.A.
Terms of Use and Disclaimers | Recommended System Requirements
Need Assistance? Please click on the Contact Us button in the top right corner of any page.